

HSA Folding Container House

<https://hsahouse.com/>



Factory and Offices



Production Equipment



全自动打孔机
Automatic punching
machine



全自动压瓦机
Automatic tile pressing
machine



框架成型机
Frame molding machine



金属隔热夹芯板生产线
YXF-Multifunctional metal sandwich panels line



焊机
Welding machine



全自动裁板机
Fully automatic plate cutting
machine



全自动切管机
Automatic tube cutting machine

Products List



Folding Container House



Expandable Container House



Flat Pack Container

Folding Container House

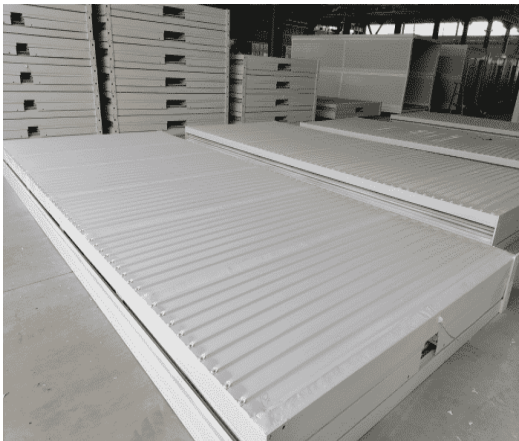

Folding container house, infrastructure, post-disaster personnel placement and emergency command post, product features: Foldable, easy to install, easy to turn around, low transportation costs

Basic parameters for folding containers			
Specifications and models	Product name	After folding (mm)	After deployment (mm)
	Standard container	3000mm*6000mm*415mm	3000mm*6000mm*2650mm
	Export containers (small)	2500mm*5800mm*360mm	2500mm*5800mm*2390mm
	Export containers	2500mm*5800mm*390mm	2500mm*5800mm*2430mm
	Other sizes	Can be customized to meet the conditions of folding	
Folding room basic parameters	Frame: concave-convex slot waterproof design, galvanized steel, galvanized square pipe, 304 stainless steel hinge and other wallboard: the use of 50 mm heat insulation rock wool color steel composite sandwich board top: the use of 104-type color steel roof, type 831 ceiling tile floor: a fire-proof cloth escape plate windows: aluminum alloy anti-theft integrated window (push-pull series) Door: Folding Room custom-built anti-theft door electrical system: Circuit Protector, five-hole socket, LED lamp, air conditioning socket, lamp switch Roof load bearing:≥600kg/m² Floor load bearing:≥600kg/m² Aisle load bearing:≥200kg/m² Wall pressure:≥80kg/m²		

Folding Container House Frame Structure

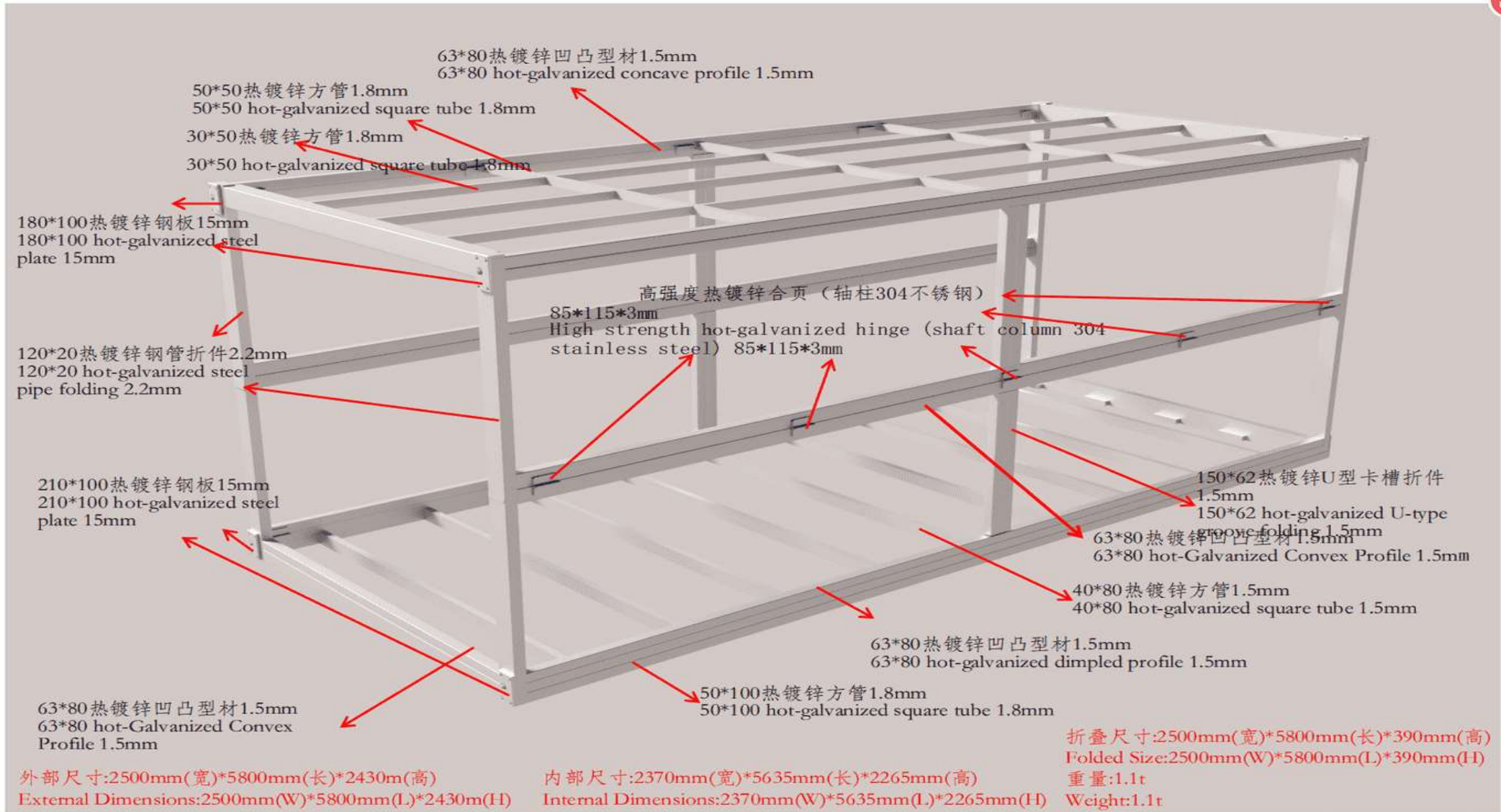

Folding Container House Material Profile

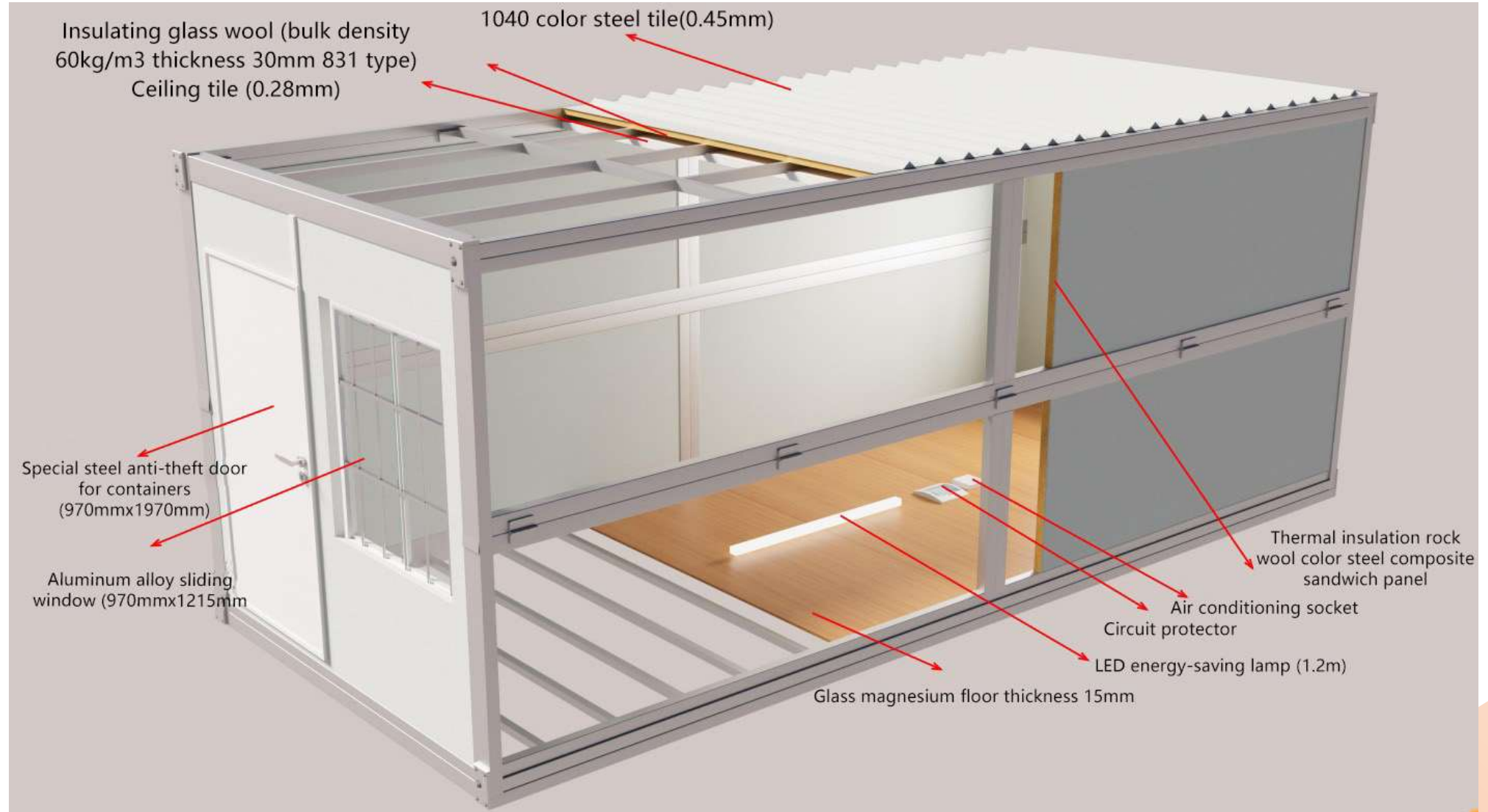

Introduction of electrical system



Main Wire, for the standard standard 4 square copper wire, switch wire and lamp wire for the standard 2.5 square and 1.5 square copper wire, for basic electricity. And according to the different export countries, custom-adapted wire. Second, electrical basic configuration, each standard box with a 60-watt LED lamp, five socket 2, switch 1,1 air-conditioning socket, leakage protector 1. Third, special requirements, according to customer requirements can be reserved circuit plus sockets and lights, additional line and switch sockets without affecting the folding, can be installed in the factory. Such as the impact of folding, can reserve a good line, accessories sent to the site installation.

Production Process



Material



Spray



Assembly-wallboard

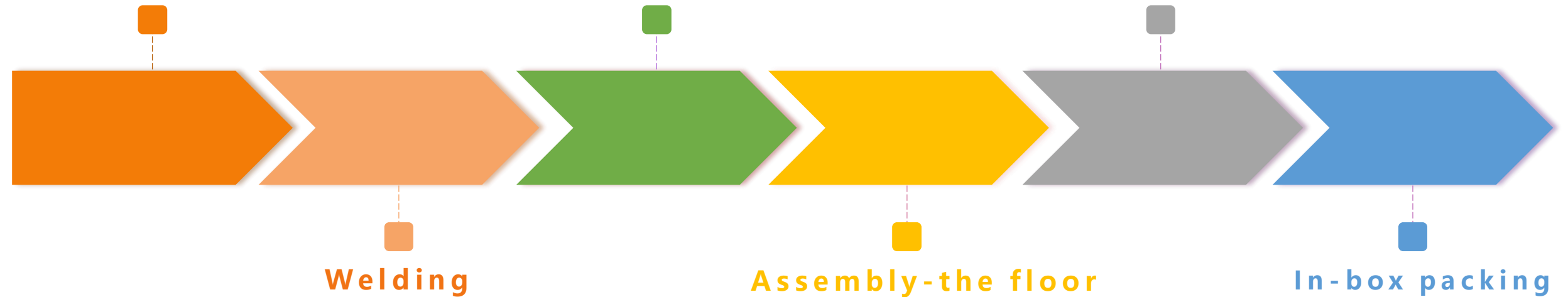

Welding



Assembly-the floor



In-box packing

Land planning and layout of folding containers

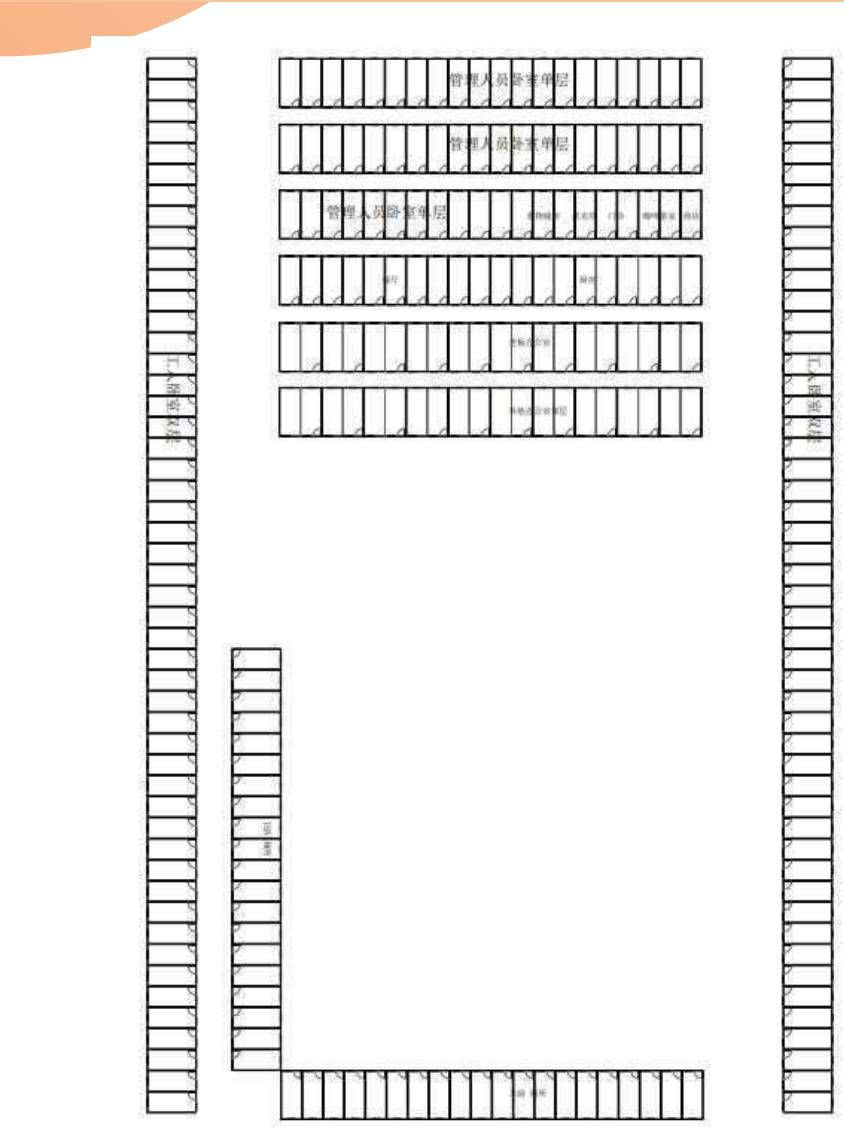

Preparation before use



1. The foundation needs to be 15cm thick with cement and 20cm thick with sand



2. Reserve a good pipe line in advance



3. After the outer pipe box is installed, it can be connected to the main pipe



Prior to installation, the crane shall be prepared to unload and unload the box

The interior layout of a folding container

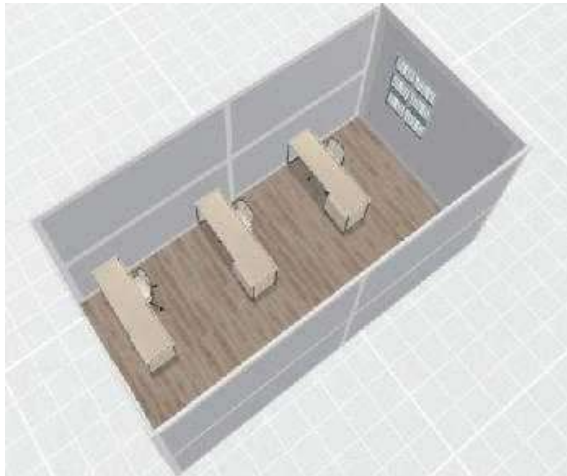
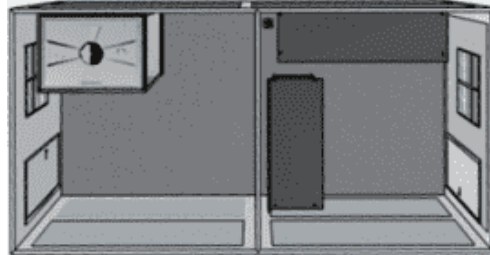
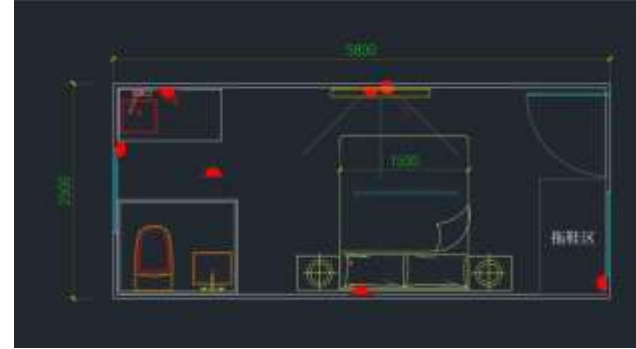
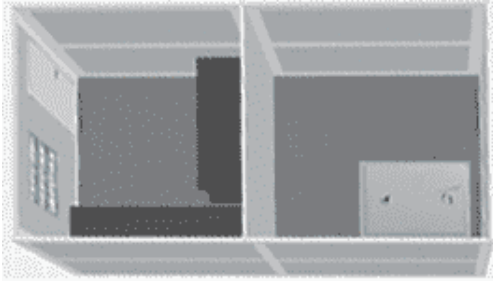

Customized folding container house case



Applicable to temporary construction site, military temporary, disaster-resistant temporary, outdoor expansion, Snack Street...



Folding Container Transport Mode



Domestic mode of transport: carts to the port, port shipping



40HQ



Bulk Carrier



Open top container

Expandable Container House

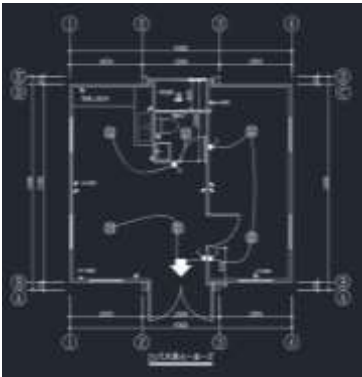

One bedroom, one living room, one kitchen and one bathroom

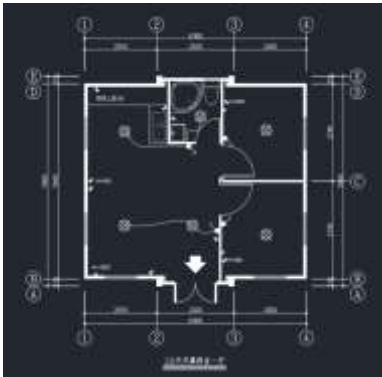

Two bedrooms, one living room, one kitchen and one bathroom

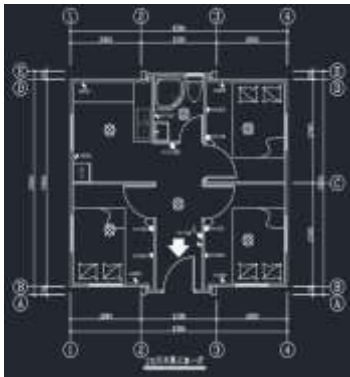

Three bedrooms, one living room, one kitchen and one bathroom

Save Storage and transport space, can be quickly deployed and assembled, lightweight and strong, reusable, better living experience, the overall aesthetic generous.

Expand the box parameters

Specifications and models	External dimensions : L5900*W6440*H2500
	Internal dimensions : L5640*W6340*H2250
	Folding dimensions : L5900*W2280*H2500
Expansion box basic parameters	Frame: C-steel, galvanized steel, galvanized square pipe self-made round pipe hinge with Shaft 4MM, special waterproof folding wallboard: 50MM thick 12g foam board, double-side iron sheet 0.35 mm top: 0.4 mm skin top + moisture-proof film + 50 mm cotton roll insulation floor, windows, doors, electrical system according to customer requirements custom roof load: 0.5 kn/m2 wall pressure: 0.5 kn/m2 fire grade: A level of fire and earthquake resistance level: 10 level of earthquake and wind resistance level: 17 level of wind resistance life: design life of 30 years

Expandable Container House



The folding biplane expansion box is an innovative design that can be easily unfolded in a short period of time and provides spacious interior space. You can according to their own needs free layout, to meet the needs of a variety of indoor layout. Whether it is office, or personalized living, folding biplane expansion box can provide you with the ideal solution. Our products are not only practical, but also beautiful and personalized. You may carry on the personalized decoration according to the personal preference, causes it to meet your demand.

At the same time, we also provide customized services, according to your requirements for the appearance of the design, interior layout design to make it more compatible with your scene. It's long life, using high-quality materials and sophisticated technology, you can provide long-term use value.

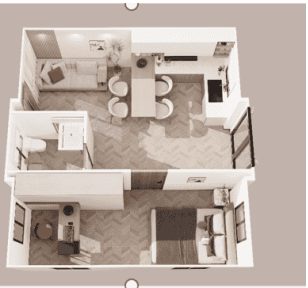

One bedroom, one living room, one kitchen and one bathroom

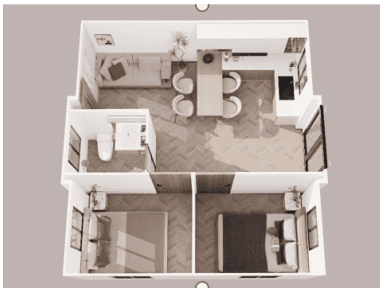

Two bedrooms, one living room, one kitchen and one bathroom



Three bedrooms, one living room, one kitchen and one bathroom

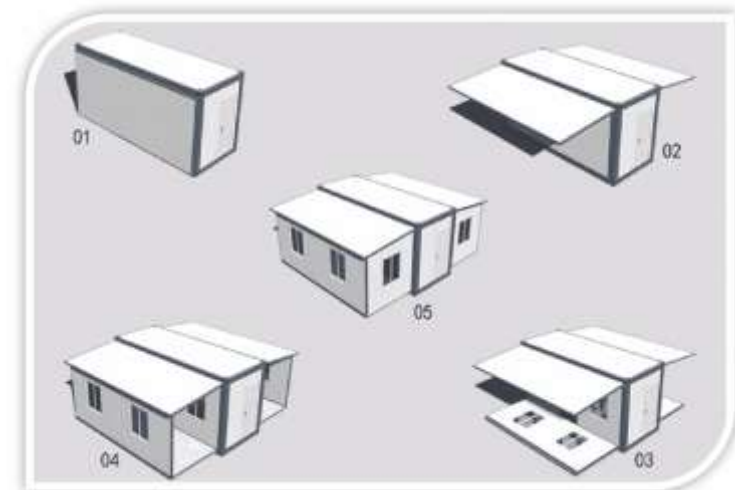

Expandable Container House frame structure diagram

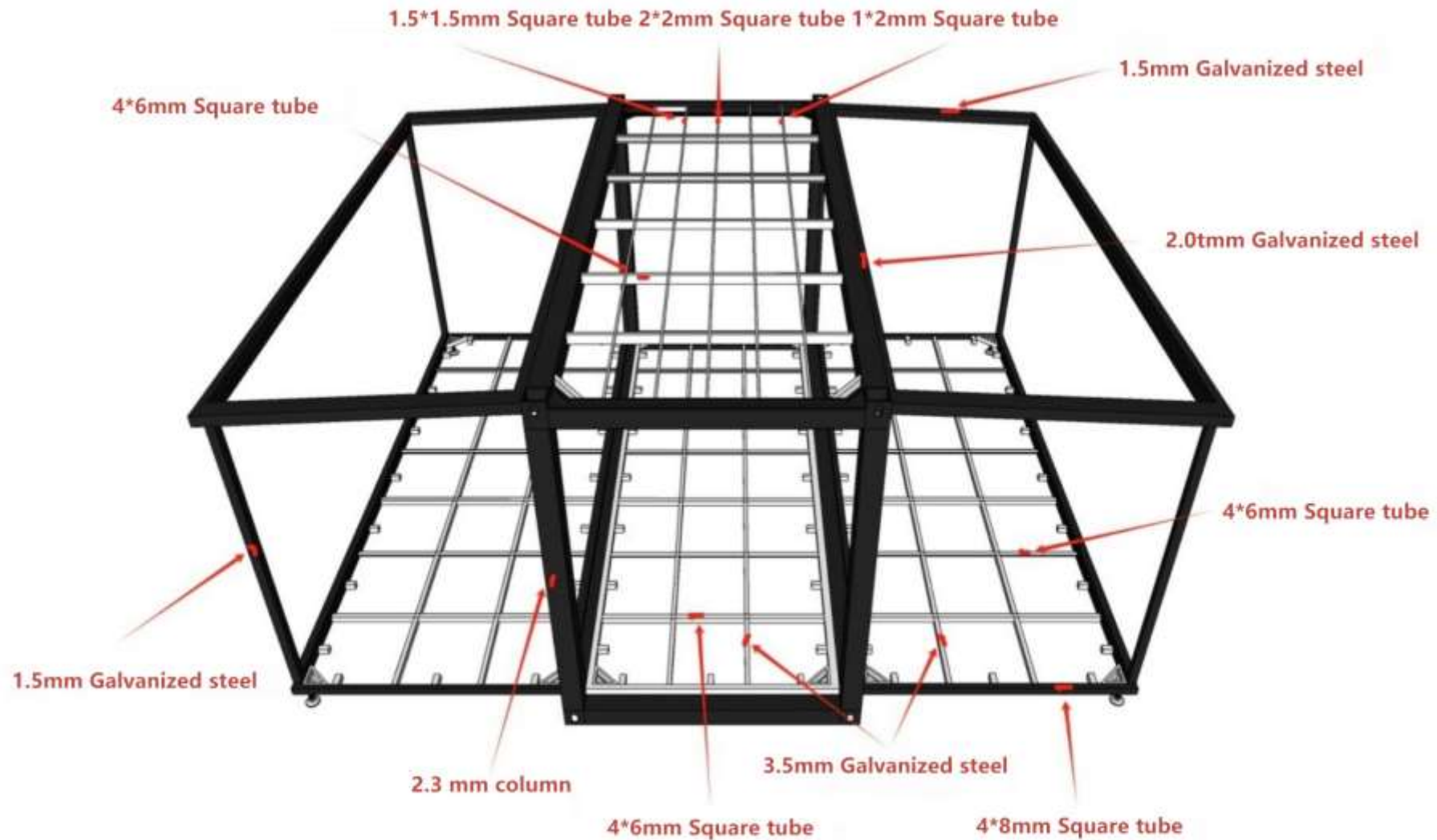

Expandable Container House Case



Flat Pack Container



Strong load-bearing, easy to transport and build, save construction time and cost, use of recyclable materials, can be customized design, in line with national safety standards.

Collapse packing box parameter	
Specifications and models	2500*5800mm*2490mm
Basic packing box parameters	Frame: galvanized steel, Galvanized Square pipe wallboard: 50mm rock wool board top: skin roof 0.4 color steel single tile, vault, drainage floor within four weeks: cement fibreboard/magnesium plate windows: plastic steel security windows: High-grade steel door electrical system: distribution box, leakage protection, five-hole socket, switch, three-hole socket, purification lamp fire grade: A level of fire and earthquake-resistant grade: 10 earthquake and wind-resistant grade: 10 wind-resistant Life: Design Life of 15 years

ENDING

Thanks for Watching

<https://hsahouse.com/>

